

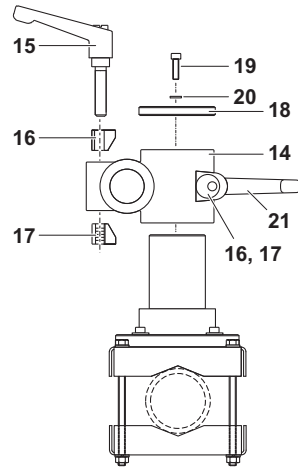

a xylem brand

Installation instructions



Attach the double junction clamp to the pivot bracket and secure it with the retaining disk (18), hexagon socket head cap screw (19) and washer (20).

Note on funktion:
Open the clamping lever only up to the point where the outrigger can be moved. If the clamping lever is unscrewed completely the wedges can get lost!

Technical Data

Materials

Pos.	Material
14	Cast aluminum
15, 21	Plastic-coated zinc die cast, with stainless steel screw 1.4305 (V2A)
1-5, 7-13, 19	Stainless steel 1.4301
16, 17	Stainless steel 1.4301
6, 18	POM

BE/R 170-D

To adjust the orientation of the lever, pull the lever, then turn and release

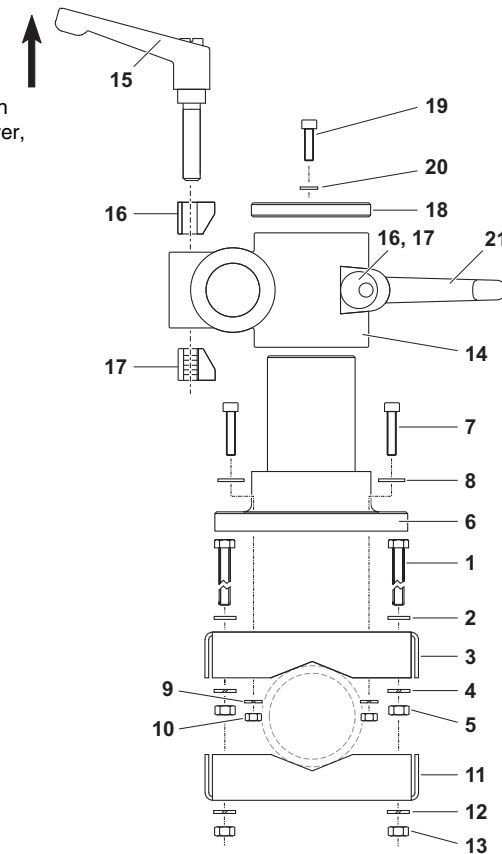

Parts list

Pos.	Quantity	Designation
1	4	Hexagon head bolt M6 x 10
2	4	Lock washer A6.4
3, 11	2	Clamping device
4, 12	6	Lock washer B6
5, 13	6	Nut M6
6	1	Pivot bracket
7	4	Hex. socket head cap screw M5 x 25
8	4	Washer A5.3 (large)
9	4	Lock washer B5
10	4	Nut M5
14	1	Double junction clamp body
15	1	Clamping lever M8 x 40
16	2	Wedge without thread
17	2	Wedge with thread
18	1	Retaining disk
19	1	Hex. socket head cap screw M5 x 18
20	1	Washer A5.3 (small)
21	1	Clamping lever M8 x 50

Assembly

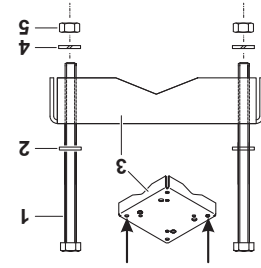

For easy assembly mount two hexagon head bolts (1) with lock washers (2) and (4) and nuts (5) to one clamping device (3).

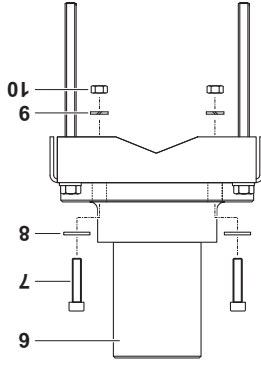

Mount the pivot bracket (6) to the clamping device using four screws (7), washers (8), lock hexagon socket head cap clamping device using four screws (7), washers (8), lock washers (9) and nuts (10).

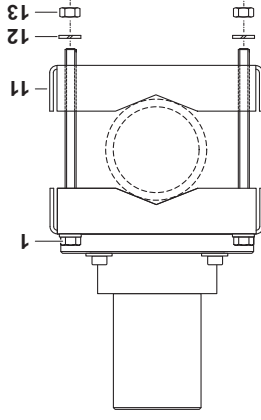

Mount the unit to the railing using the other two hexagon head bolts (1), the four lock washers (12) and nuts (13) and the second clamping device.